

Upright Standing Long-Neck Dinosaur

Kid-Friendly Step-by-Step Co-Build Guide & Printable Outlines



SAFETY RULES FOR THE TEAM

Grown-ups do the cutting: Children must never touch or stand near the scroll saw/hand saw while it is actively running. Keep a safe distance (5 feet away) and always wear your safety glasses.

Kids do the smoothing: Sanding, assembly testing, and organic oiling are completely safe and fun tasks for kids!

Project Quick Look

Time Needed: About 2 hours	Style: Upright Tripod Toy
Grown-up Skill: Beginner with a saw	Kid Skill: Ready to sand and assemble

How it works: You are building an upright dinosaur. Its body stands vertically. It uses its two large rear legs and its long swooping tail to form a super stable, 3-point tripod base on the floor, while its two small arms sit up high on its chest!

The Wood and Supplies You Need

- **For the Upright Body:** 1 piece of wood that is **3/4 inch thick** (about 12" x 12"). Poplar or Pine are perfect choices.
- **For the 2 Rear Legs & 2 Front Arms:** 1 piece of wood that is **1/2 inch thick** (about 6" x 12").
- **Your Tool Kit:** Blue painter's tape, glue stick, sanding block, 120-grit & 220-grit sandpaper, and food-safe Mineral Oil for the final finish.



The Slot Matching Rule!

- The 2 slots cut into the 3/4" thick Body must be exactly 1/2" wide.
- The slots cut into the 1/2" thick Legs and Arms must be exactly 3/4" wide.

Let's Build It! Step-by-Step Instructions

Step 1: Tape and Stick the Pattern

Teamwork Opportunity

Cover your wood blanks completely with blue painter's tape. Use a glue stick to paste the printable paper outline patterns (from the next page) directly on top of the tape. Make sure the body's long tail runs directly along the wood grain so it stays strong and doesn't snap.

Step 2: Cutting out the Upright Profiles

Grown-Up Task Only

Carefully cut out the unique upright body silhouette along the outer lines. Cut out the open mouth details at the top of the long vertical neck, the prominent front chest bulge, and the long sweeping tail. Next, cut the two large rear legs from your 1/2" wood, and the two smaller front arms.

Step 3: Cutting the Interlocking Slots

Grown-Up Task Only

Cut out the arm slot high up on the dinosaur's chest, and the leg slot located on the lower belly/hip curve. Cut slightly inside your layout lines so the joints stay firm and snug.

Step 4: Making It Smooth and Safe

Kid's Ultimate Task

Peel away the blue tape and paper. Use your 120-grit sanding block to flatten the sides. Then use your 220-grit sandpaper to rub all along the sharp cut edges until every part is completely round, smooth, and soft to hold.

Step 5: The Tripod Assembly Test

Teamwork Opportunity

Slide the small arms into the upper chest slot, and the large legs into the lower hip slot. Place the dinosaur onto a flat table. The two large rear legs and the tip of the long tail should all touch the ground perfectly to form a balanced tripod base!

Step 6: Oil and Bring it to Life

Kid's Ultimate Task

Rub your child-safe mineral oil all over the assembled dinosaur pieces. Watch the raw wood instantly pop into a beautiful warm golden shade. Wipe away any extra wet oil after 15 minutes. Your toy is complete!

For the Upright Body:

1 piece of wood that is 3/4 inch thick (about 12" x 12"). Poplar or Pine are perfect choices.

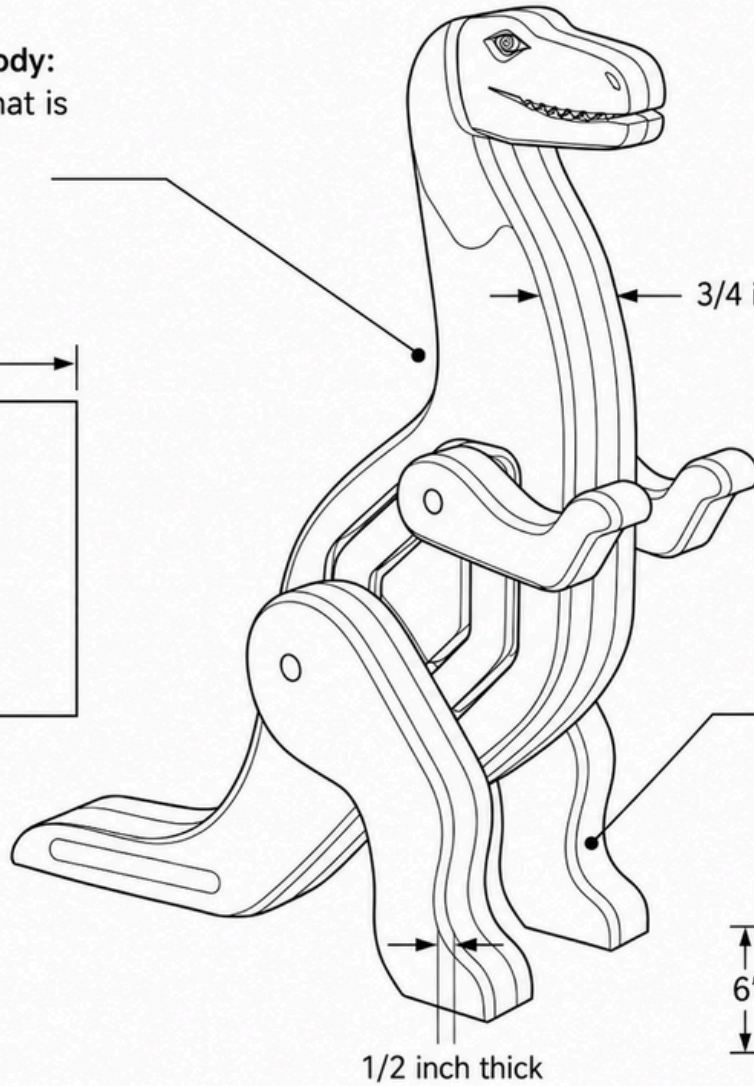
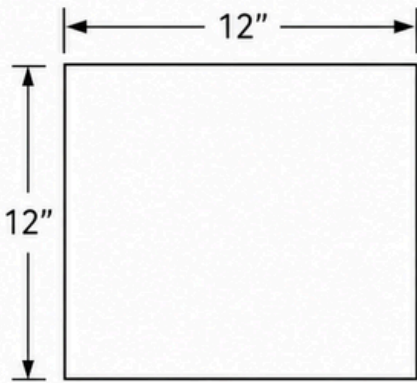

3/4 inch thick

For the 2 Rear Legs & 2 Front Arms:

1 piece of wood that is 1/2 inch thick (about 6" x 12").

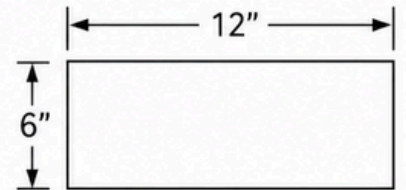

1/2 inch thick

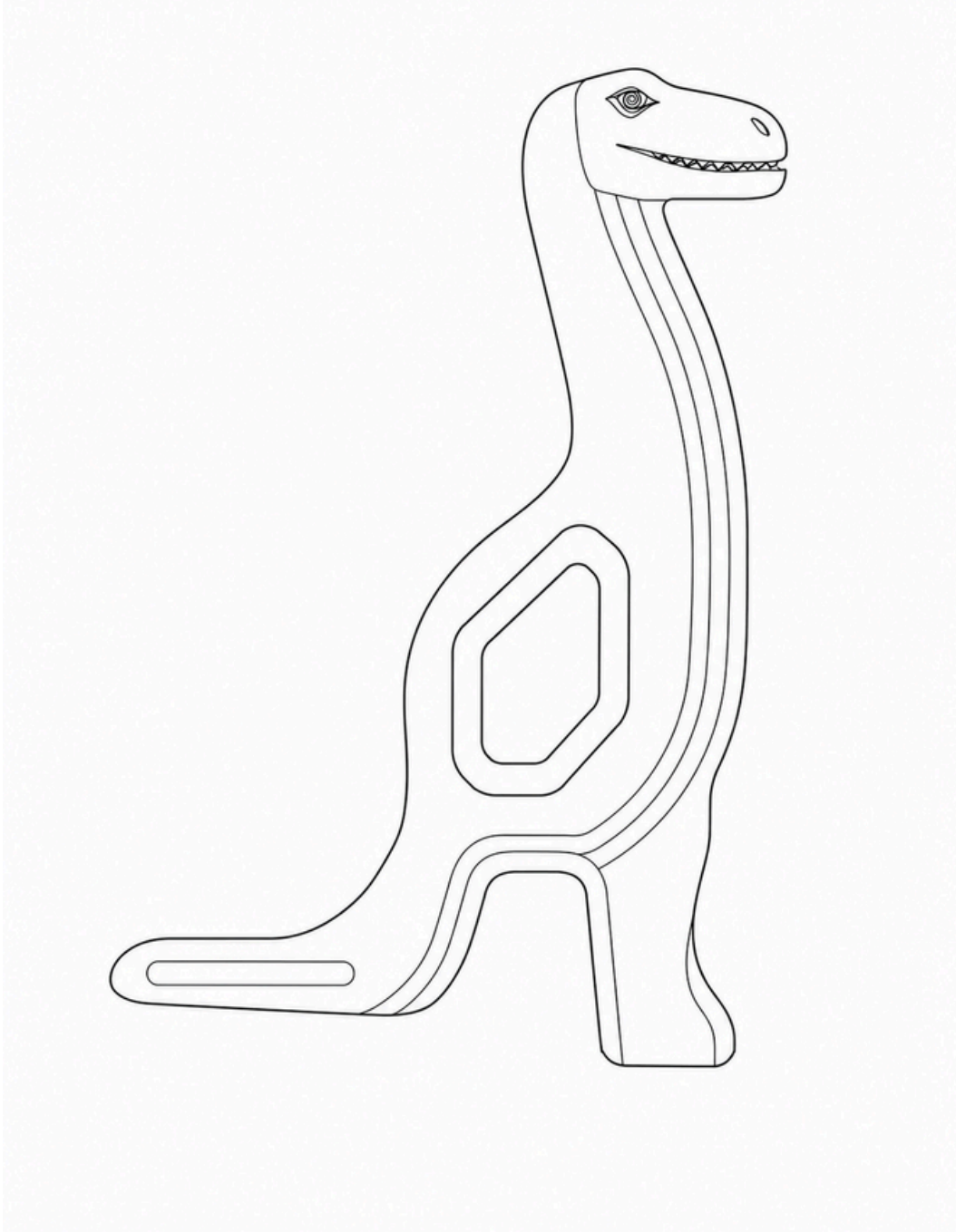

Print at 100% Scale - Do Not Shrink to Fit

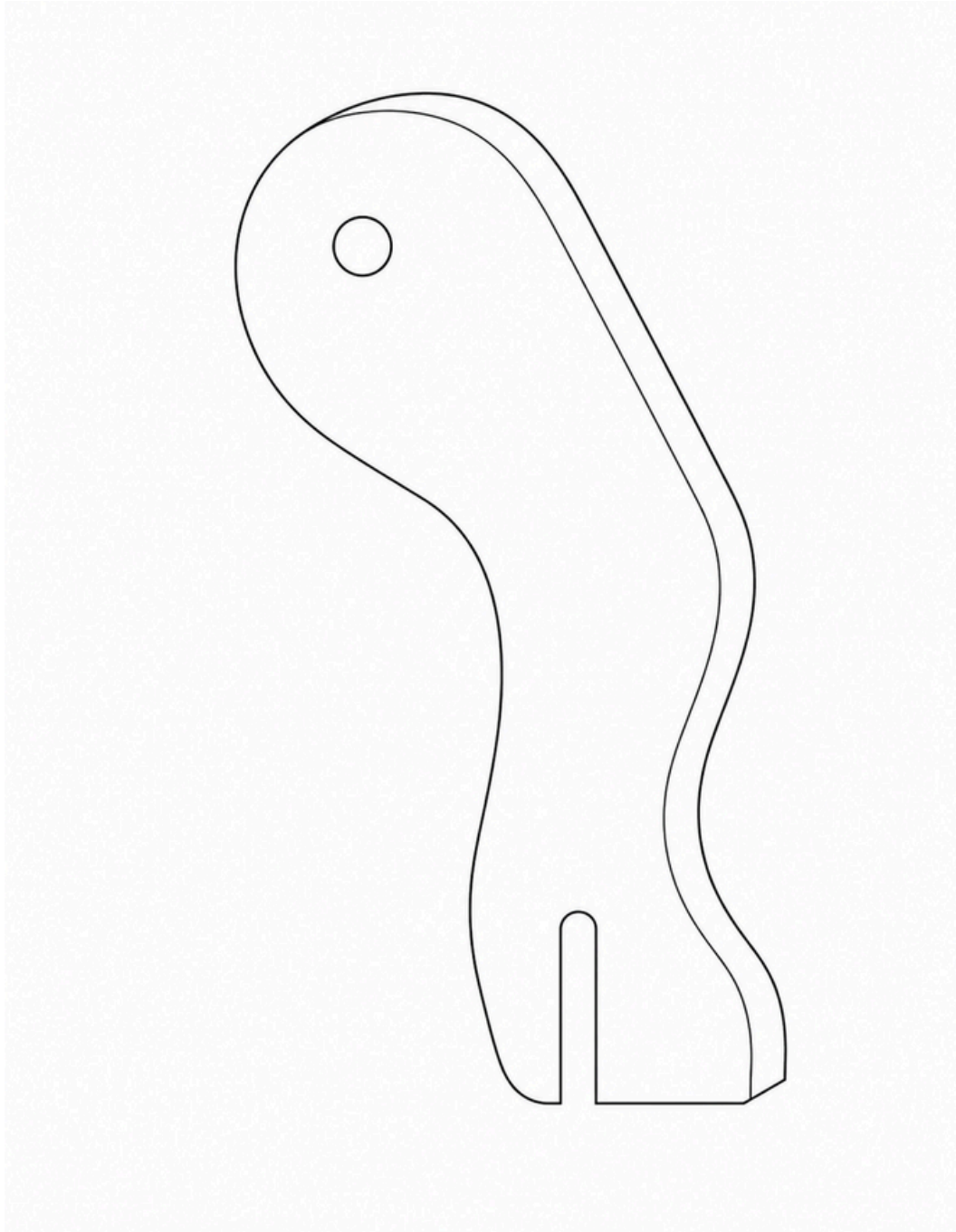

Print at 100% Scale - Do Not Shrink to Fit

